

**IMPORTANT WARNING - PLEASE READ BEFORE USING COVER!**

Do not install this product in a manner that will interfere with any vehicle occupant safety systems. This product is not designed to restrain pets, occupants, or cargo in the event of a collision.

**SEAT PROTECTOR INSTALLATION**

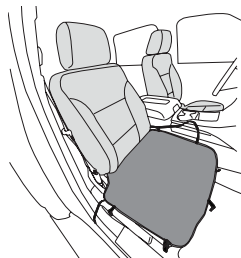

**STEP 1**

Lay the seat cover on the seat with the top portion folded down.

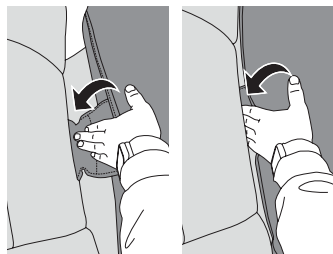

**STEP 2**

Push the anchor pillow fully into the fold of the seat.

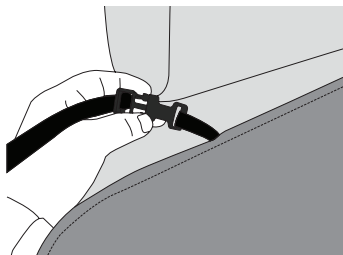

**STEP 3**

Lift the upper portion of the seat cover up and bring the upper strap around the headrest and connect the buckle.

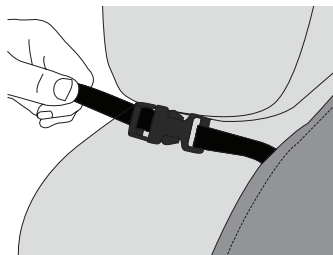

**STEP 4**

Pull the strap to adjust the tension.

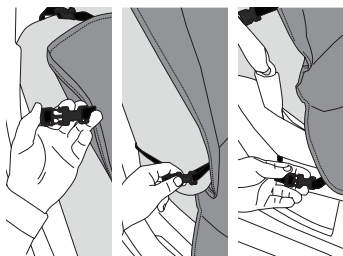

**STEP 5**

Repeat the process with the remaining three (3) straps and buckles.



**STEP 6**

Installation complete.

**NOTE:** Do not install the seat cover if any straps will interfere with side impact airbag deployment.

**CLEANING INSTRUCTIONS:**

1. Using a large commercial washer without agitator, wash the cover using 1/4 cup of a gentle detergent\*, without bleach, in cold water. Do not pour detergent directly onto the cover.
2. Rinse the cover twice (2x) to remove all the detergent.
3. Hang and allow to air dry.

**SPOT-CLEANING INSTRUCTIONS:**

1. Mix one ounce of a gentle detergent\*, without bleach, per quart of warm water.
2. Spray or sponge onto cover.
3. Rinse with plain water (until no suds) and allow to air dry.

**\*NOTE:** Do NOT use any detergent with fabric softeners in it. Fabric softeners will cause the water repellency to not work properly.

If you encounter any problems during the installation of your seatback organizer, please contact our customer service department: Monday-Friday, 9AM-7PM (EST) at **800-274-7006** or by e-mail at **sales@covercraft.com**. You may also access help videos on the web at **covercraft.com**.